



University of the Philippines **OPEN UNIVERSITY**

BIDS AND AWARDS COMMITTEE



12 September 2024

SUPPLEMENTAL BID BULLETIN NO. 24-013

This Supplemental Bid Bulletin No. 24-013 is to amend or modify items in the Bid Documents and in response to the queries raised during the pre-bid conference conducted on 10 September 2024 for “Supply of Labor and Materials for the Replacement of FDAS at the Administration Bldg. and CCDL Bldg.” to wit:

Item/Query	Answers
1. With regards to the PCAB License, our classification is Mechanical Works and Fire Protection Works, Category D, can it be considered?	Valid PCAB License and Registration: Small B (minimum size range); Specialty – Fire Protection Works; Category C or D (minimum license category)
2. Can we request for a copy of the floor plan?	See attached Floor Plans of Admin. and CCDL and Learning Hall Bldg.
3. Do you have any requirements like for example a minimum of EN-Listed brand or product?	Certification Requirement for the FDAS to be offered: Must be UL-listed (Underwriters Laboratories) or conforms to the EN 54 Standard Series (European Norm)

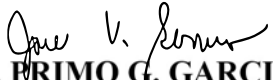
For the guidance and information of all concerned bidders.

 for
Dr. IRIMO G. GARCIA
Chair, BAC 

Received by the Bidder:

_____ Date: _____

Signature over printed name

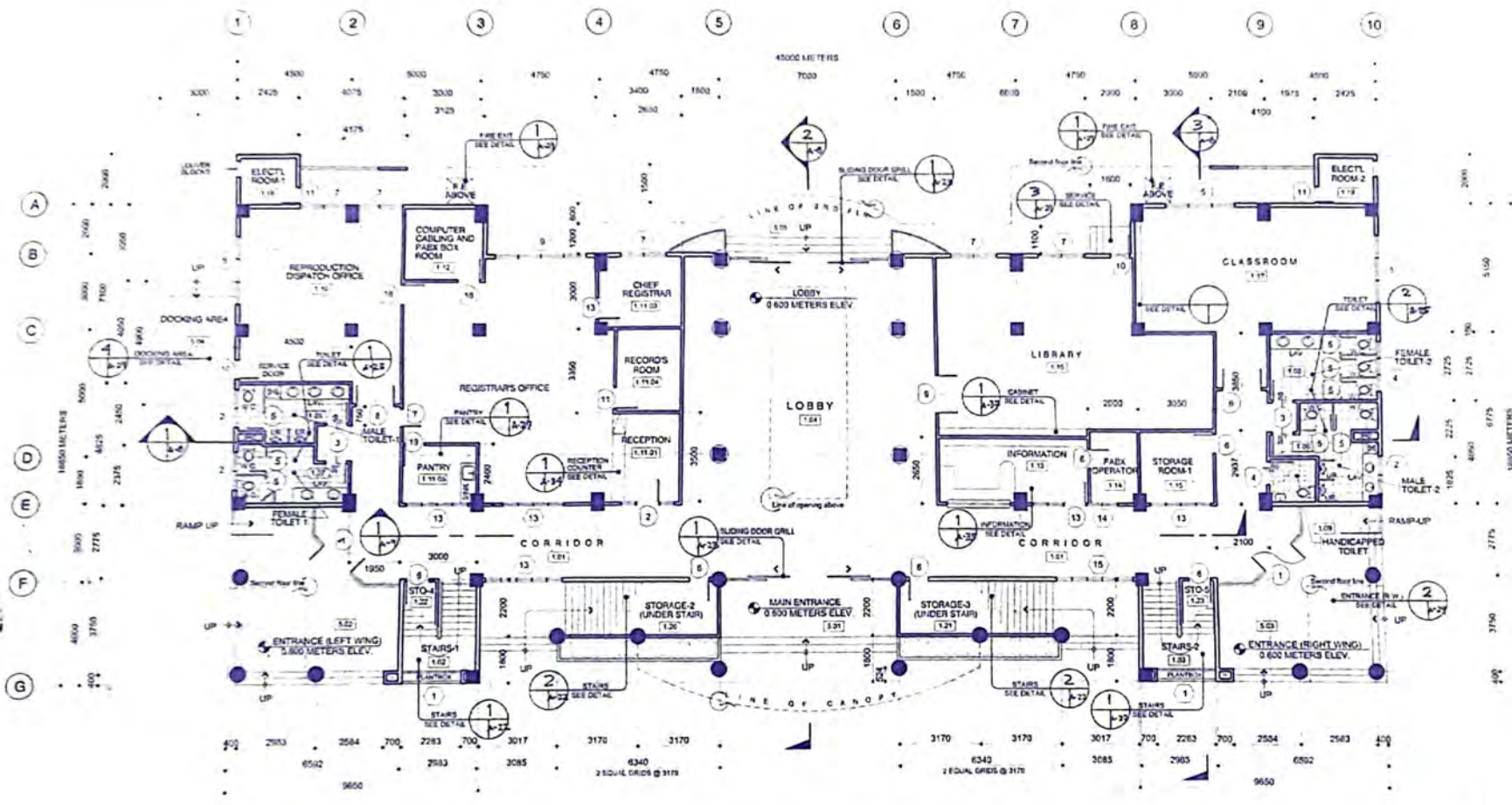

1 GROUND FLOOR PLAN
SCALE: 1:100 MTS.

- LEGEND**
- W2 WINDOW TYPE
 - D1 DOOR TYPE
 - 1.07 ROOM NUMBER
 - ENTRANCE (RIGHT WING) 0.55 METERS ELEV. FLOOR LEVEL FLOOR ELEVATION
 - 50 CHANGE FLOOR ELEV
 - TOILET SEE DETAIL DET. DWG DESIGNATION DET. DWG SH. NO.

DAVID ALLI CRUZ YAZON
Architects / Planners

ARCHITECT	ENGINEER	PROJECT TITLE / LOCATION	APPROVED	DATE	SHEET CONTENT'S	REVISIONS	DATE	SHEET NO.
NESTOR S. DAVID, UAP		PROPOSED THREE-STOREY BUILDING U.P. OPEN UNIVERSITY LOS BAÑOS, LAAGUNA	<i>[Signature]</i>	11-1-98	GROUND FLOOR PLAN		11-27-98	A-3
PTN No. 000189-F Reg. No. 2780 Issued on 1-13-88 TKN 110-138-413 Issued at QUEZON CITY	PTN No. _____ Reg. No. _____ Issued on _____ TKN _____ Issued at _____	OWNER				DESIGNED	DRAWN	
<small>*Disclaimer: These drawings are representations of services, not the property and instruments of the architect. For all the U.P. and for any persons, without the written consent of the architect, no part of these drawings shall be reproduced, stored in a retrieval system, or transmitted in any form or by any means, electronic, mechanical, photocopying, recording, or by any information storage and retrieval system, without the prior written permission of the architect.</small>		UNIVERSITY OF THE PHILIPPINES				CHECKED	APPROVED	

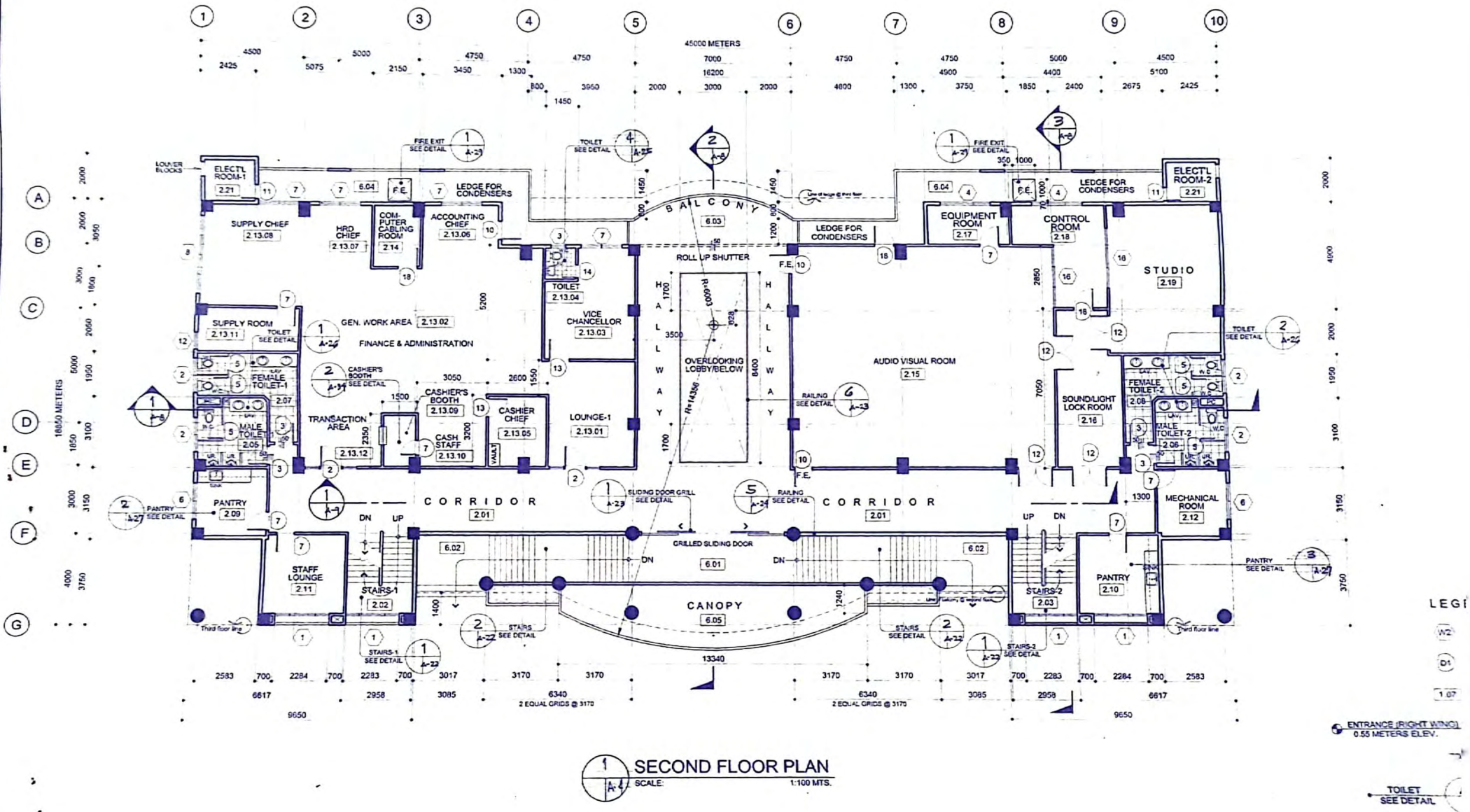

1 SECOND FLOOR PLAN
SCALE: 1:100 MTS.

ENTRANCE (RIGHT WING)
0.55 METERS ELEV.

TOILET
SEE DETAIL

- LEG
- W2
 - D1
 - 1.07

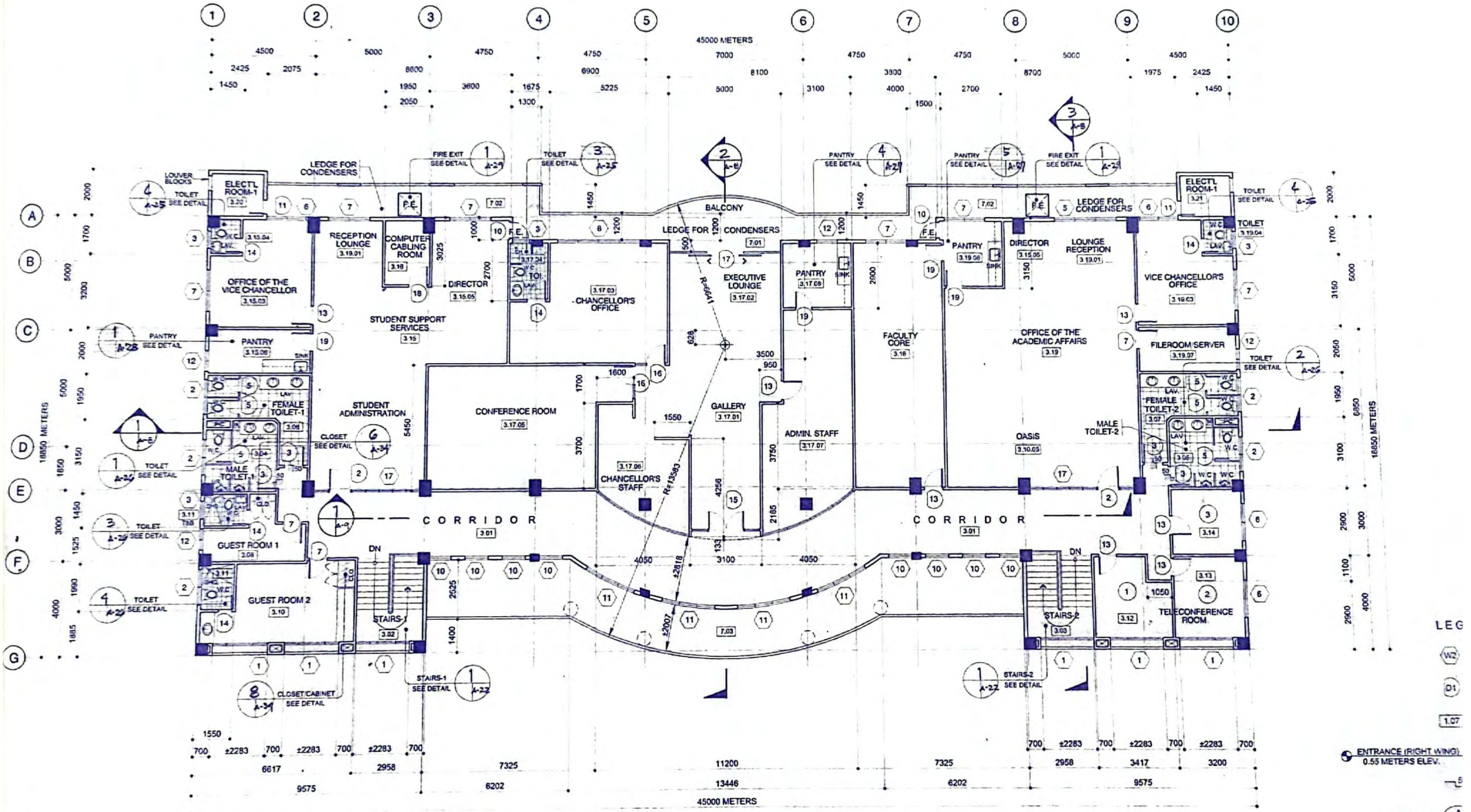

THIRD FLOOR PLAN
SCALE: 1:100 MTS.

- LEG
- W2
- D1
- 1.07
- ENTRANCE (RIGHT WING)
0.55 METERS ELEV.
- TOILET SEE DETAIL



ARCHITECT	ENGINEER	PROJECT TITLE / LOCATION	APPROVED	DATE	SHEET CONTENT/S	REVISIONS
NESTOR S. DAVID, UAP		PROPOSED THREE-STORY BUILDING U.P. OPEN UNIVERSITY LOS BAÑOS, LAGUNA			GROUND FLOOR PLAN	
PTR No. 0205189 Y Reg. No. 2780	PTR No. Reg. No.					

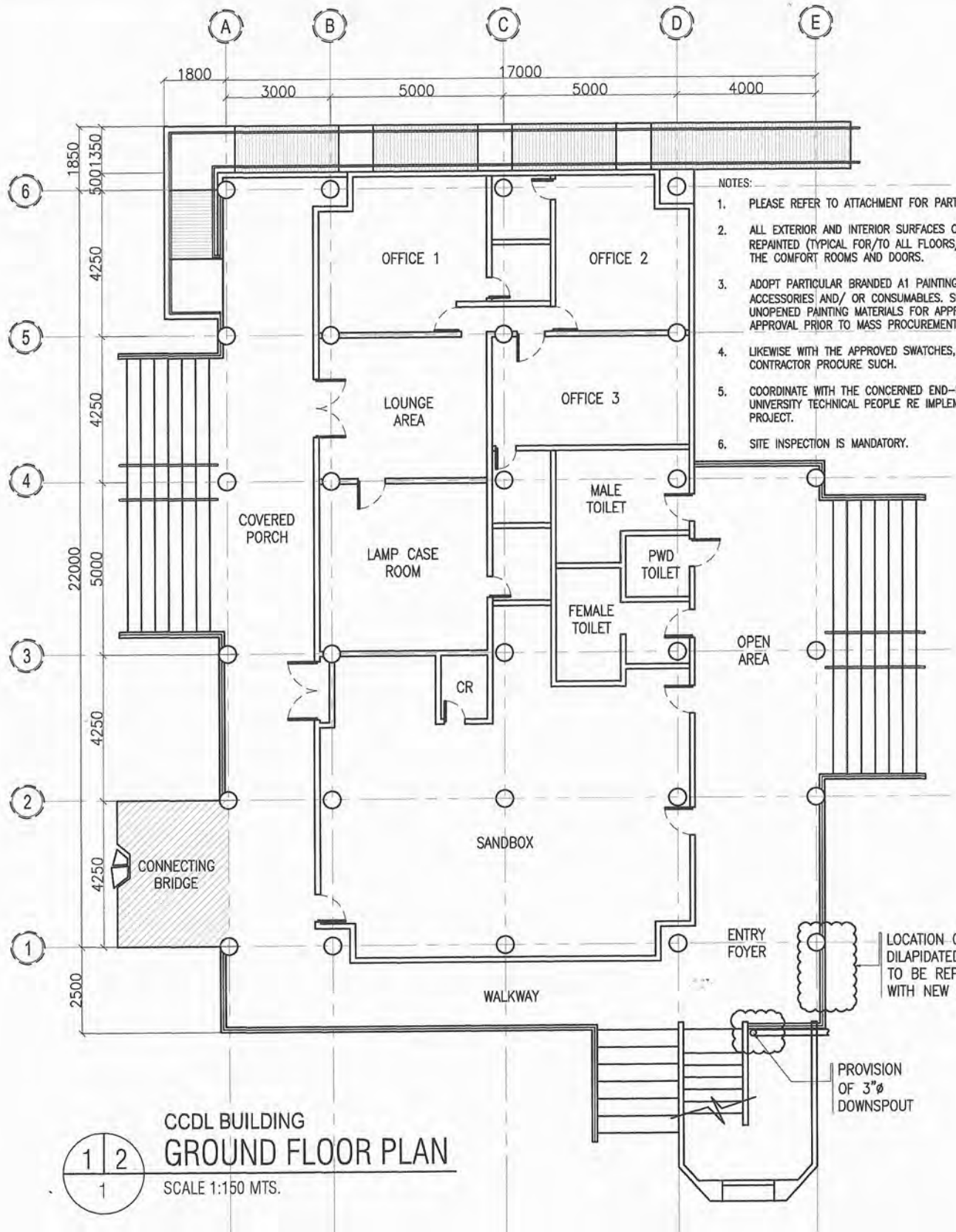

- NOTES:
1. PLEASE REFER TO ATTACHMENT FOR PARTICULAR SCOPE OF WORK.
 2. ALL EXTERIOR AND INTERIOR SURFACES OF THE BUILDING SHALL BE REPAINTED (TYPICAL FOR/TO ALL FLOORS/ LEVELS) EXCEPT FOR THE COMFORT ROOMS AND DOORS.
 3. ADOPT PARTICULAR BRANDED A1 PAINTING MATERIALS INCLUDING ACCESSORIES AND/ OR CONSUMABLES. SUBMIT SAMPLES OF UNOPENED PAINTING MATERIALS FOR APPROPRIATE CHECKING AND APPROVAL PRIOR TO MASS PROCUREMENT.
 4. LIKewise WITH THE APPROVED SWITCHES, ONLY CAN THE CONTRACTOR PROCURE SUCH.
 5. COORDINATE WITH THE CONCERNED END-USERS AND OPEN UNIVERSITY TECHNICAL PEOPLE RE IMPLEMENTATION OF THE PROJECT.
 6. SITE INSPECTION IS MANDATORY.

CCDL BUILDING
GROUND FLOOR PLAN
 SCALE 1:150 MTS.

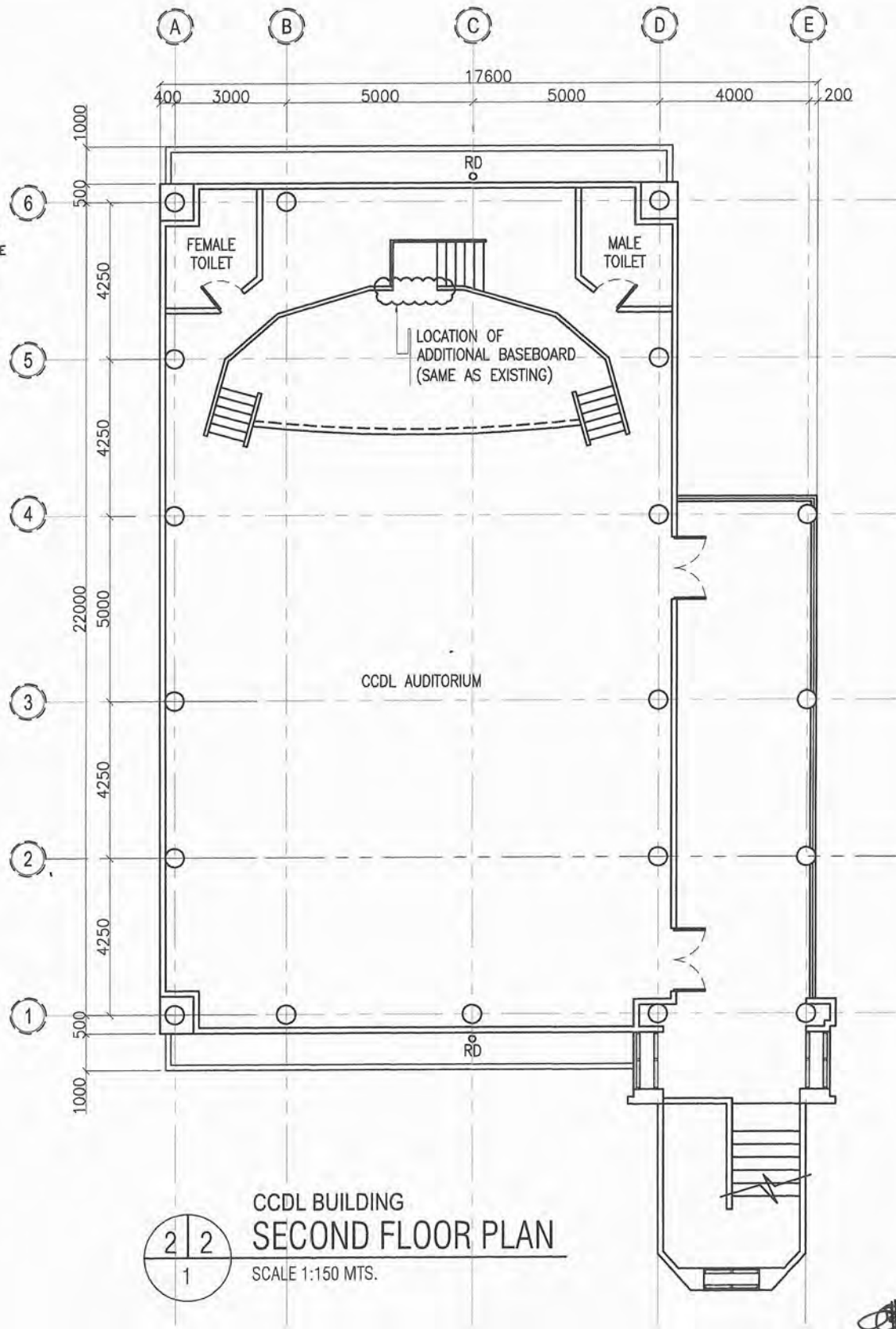

CCDL BUILDING
SECOND FLOOR PLAN
 SCALE 1:150 MTS.

Handwritten signature

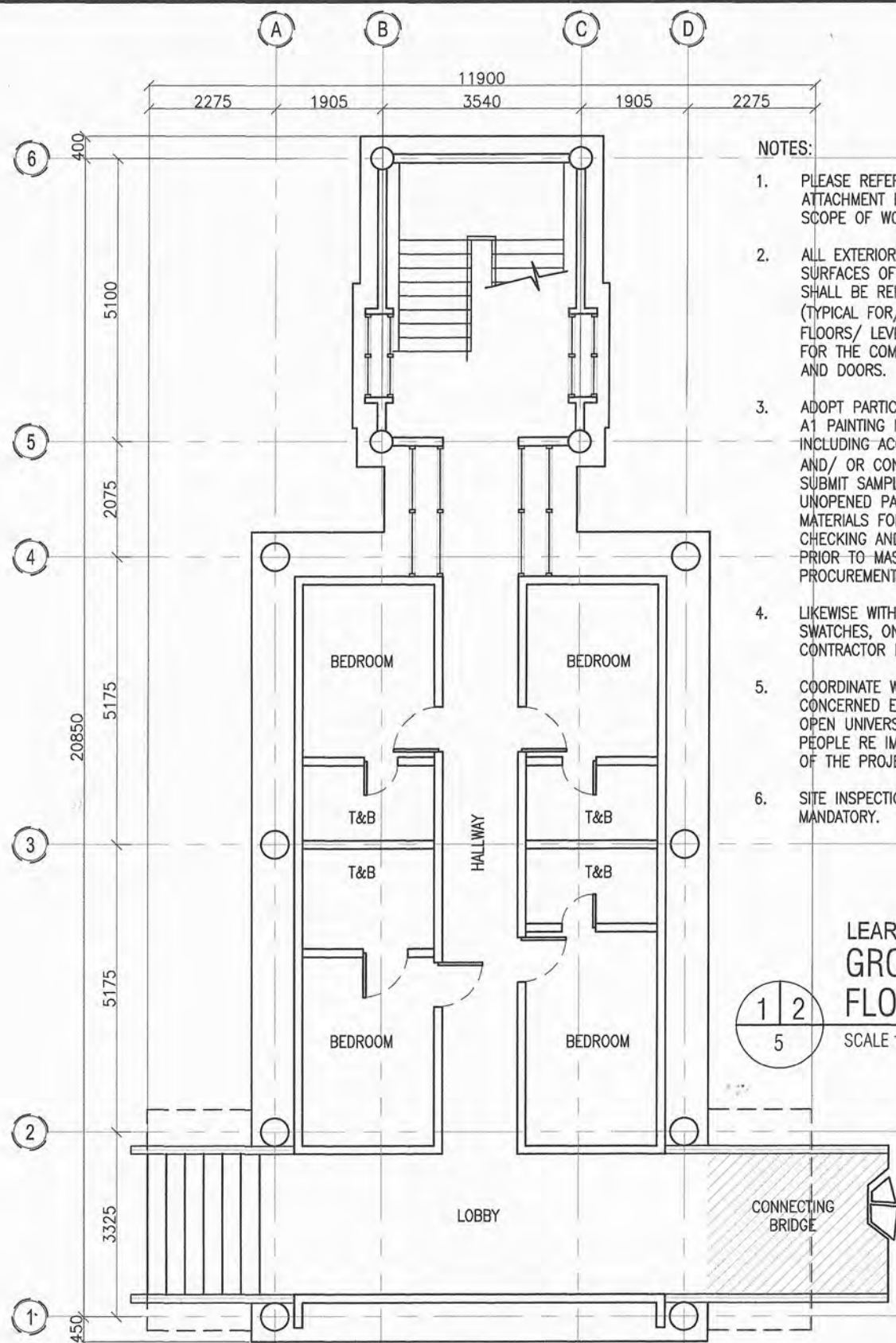

NOTES:

1. PLEASE REFER TO ATTACHMENT FOR PARTICULAR SCOPE OF WORK.
2. ALL EXTERIOR AND INTERIOR SURFACES OF THE BUILDING SHALL BE REPAINTED (TYPICAL FOR/TO ALL FLOORS/ LEVELS) EXCEPT FOR THE COMFORT ROOMS AND DOORS.
3. ADOPT PARTICULAR BRANDED A1 PAINTING MATERIALS INCLUDING ACCESSORIES AND/ OR CONSUMABLES. SUBMIT SAMPLES OF UNOPENED PAINTING MATERIALS FOR APPROPRIATE CHECKING AND APPROVAL PRIOR TO MASS PROCUREMENT.
4. LIKEWISE WITH THE APPROVED SWATCHES, ONLY CAN THE CONTRACTOR PROCURE SUCH.
5. COORDINATE WITH THE CONCERNED END-USERS AND OPEN UNIVERSITY TECHNICAL PEOPLE RE IMPLEMENTATION OF THE PROJECT.
6. SITE INSPECTION IS MANDATORY.

**LEARNER'S HALL
GROUND
FLOOR PLAN**

SCALE 1:100 MTS.

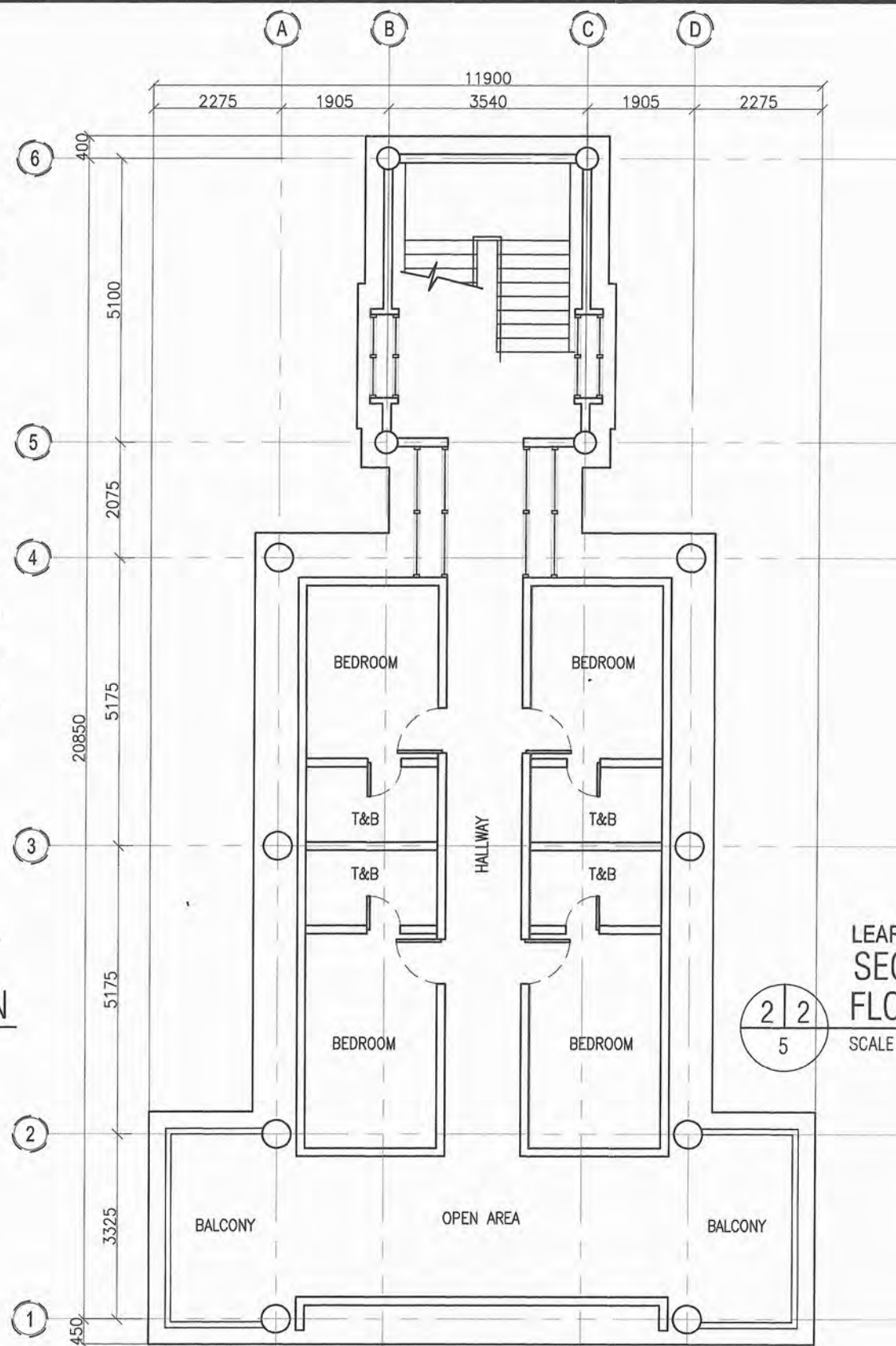

**LEARNER'S HALL
SECOND
FLOOR PLAN**

SCALE 1:100 MTS.

